

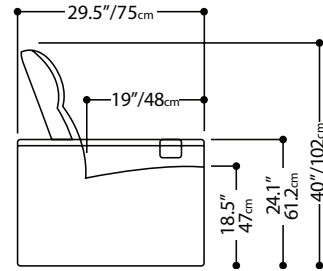

R1 SERIES

Arm Width: 5.5"/14cm | Standard Seat Width: 20.5"/52cm

FULL UPRIGHT POSITION:



FULL RECLINE:

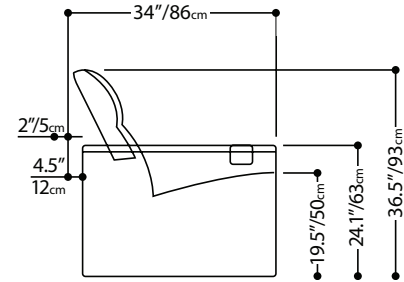

FEATURES

Easy to clean, stainless steel cup-holder that removes with two screws for simple replacement.

High-resiliency seat foam offers superior durability and comfort.

OPTIONS

Factory-installed LED seat number to guide guests to their seats

Factory-installed LED aisle letter to guide guests to the correct row

Fixed or removable tray provides added convenience and comfort for dining guests

LED path light that illuminates the end of the row

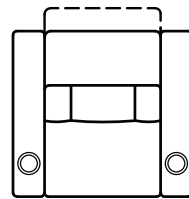

1N: Two Arm
Non Recliner
W: 31.25"/79.4cm

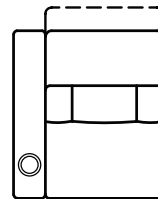

2N: Right Arm
Non Recliner
W: 25.75"/65.4cm

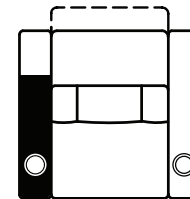

3N: Left Arm
Non Recliner with Transfer
Lift Arm (ADA)
W: 31.25"/79.4cm

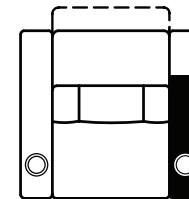

4N: Right Arm
Non Recliner with Transfer
Lift Arm (ADA)
W: 31.25"/79.4cm

CONFIGURATIONS

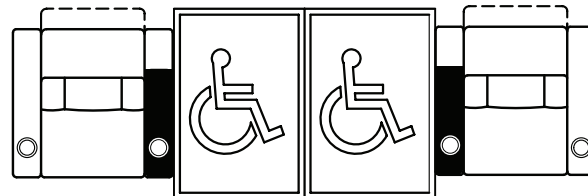

ADA Seating Configuration: 4N / 3N
Width: 128.5"/326.4

encore
by Palliser®

encore.palliser.com

Specifications are correct at time of printing and are subject to change without notice.